



Kubota®

**T R A C T O R
L I N K A G E &
A C C E S S O R I E S
C A T A L O G**



Forged Top Links

- Quality forged top links available in Category 0, 1 and 2
- All top links are yellow zinc plated
- The ends are clear zinc plated

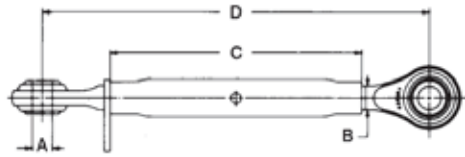

Item No.	Cat.	A Pin Hole Size	B Thread Diameter	C Body Length	D Closed Length	Open Length	Color
77700-06378	0	5/8"	3/4" NC	7-5/8"	11"	16"	Plated
70000-16652	1	3/4"	1-1/8" NC	13-1/4"	17"	26"	Plated
70000-16576	1	3/4"	1-1/8" NC	16"	21"	28"	Plated
70000-73347	2	1"	1-1/8" NC	16"	21"	31"	Plated



Forged Weld-on Top Link Ends

- High-quality weld-on top link ball sockets in Category 1 and 2 sizes

Item No.	Description
77700-06417	Category 1 forged top link end, 3/4" pin hole
77700-06418	Category 2 forged top link end, 1" pin hole

Top Link Reducer Bushings

- Used in the pin hole of a top link to allow a smaller category pin to fit
- Yellow zinc dichromate plated
- See page 7 for countertop display



Item No.	Cat.	Description	Outside Diameter	Inside Diameter	Length
70000-16633	0-1	Fits all Cat. 0 top link pins	3/4"	5/8"	1-5/8"
70000-16635	1-2	Fits all Cat. 1 top link pins; replaces Ford C7NN6993A	1"	3/4"	1-15/16"
70000-73597	1-2	Fits all Cat. 1 top link pins; short	1"	3/4"	1-5/8"
70000-16637	2-3	Fits all Cat. 2 top link pins	1-1/4"	1"	1-15/16"



Lift Arm Reducer Bushings

- Used in the pin hole of a lift arm to allow a smaller category pin to fit
- Yellow zinc dichromate plated
- See page 7 for countertop display

Item No.	Cat.	Description	Outside Diameter	Inside Diameter	Length
70000-73314	0-1	Fits all Cat. 0 lift arm pins	7/8"	5/8"	1-3/8"
70000-16632	1-2	Fits all Cat. 1 lift arm pins; Ford C7NN6992A	1-1/8"	7/8"	1-3/4"
70000-16634	1-2	Fits all Cat. 1 lift arm pins; replaces John Deere F2684	1-1/8"	7/8"	1-3/8"
70000-16636	2-3	Fits all Cat. 2 lift arm pins	1-7/16"	1-1/8"	1-3/4"
70000-16638	2-3	Fits all Cat. 2 lift arm pins; 15/32" lynch pin hole	1-7/16"	1-1/8"	2-1/2"

Top Link & Lift Arm Replacement Balls

- Top link and lift arm balls for Ford, John Deere, Oliver and other tractors
- Designed to replace original balls
- Yellow zinc dichromate plated



Item No.	Cat.	Description	Pin Hole Size	Length Thru Bore	Ball Diameter
70000-16587	1	John Deere & Oliver top link ball; replaces Deere F2680, Oliver 105968A	3/4"	1-3/4"	2"
70000-16588	2	John Deere & Oliver top link ball; replaces Deere F2681, Oliver 104585A	1"	1-3/4"	2"
70000-16589	1	Ford lift arm ball; replaces Ford DDN995233; fits Ford 5000	7/8"	1-3/8"	2-1/4"
70000-16590	2	Ford lift arm ball; replaces Ford C5NN557A; fits Ford 3000, 4000, 5000	1-1/8"	1-3/4"	2-1/4"
70000-16592	2	Oliver lift arm ball; replaces Oliver 104591A; fits all models with claw type lift arm	1-1/8"	1-3/4"	2"
70000-73949	2	Ford lift arm ball; narrow width; replaces C5NN557B	1-1/8"	1-3/8"	2-1/4"



Drawbar

Drawbars

- One piece 3-point hitch cross drawbars to fit Cat. 0 through Cat. 2 tractors

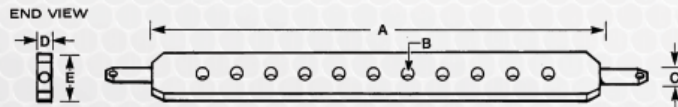

Drawbar Lock

Item No.	Cat.	Number of Holes	A Lift Arm Spacing	B Hole Diameter	C Pin Diameter	D Thickness	E Width	Color	
70000-73951	0	7	20"	5/8"	5/8"	5/8"	2"	Black	
70000-16651	0/1	7	20"	3/4"	7/8"	1"	2-1/2"	Black	
70000-16594	1	11	26"	3/4"	7/8"	1"	2-1/2"	Black	
70000-16597	2	11	26"	3/4"	1-1/8"	1-1/4"	3"	Black	
77700-06419	Drawbar lock for category 1 tractors; prevents drawbar on 3-point hitch from rotating								

Lift Arms & Lift Arm Parts

Item No.	Description
70000-16593	Category 1 right or left hand forged lift arm; fits all Ferguson models, Ford 2N, 8N, 9N, NAA, Massey-Ferguson 35, 50, Oliver 550 and Oliver 3-point conversion, John Deere 1010; 7/8" pin holes; 31-3/4" ball centers; 34-1/2" overall length; painted black
70000-73317	Category 1 forged right or left hand straight lift arm repair end; 7/8" pin hole; 4" overall length
70000-73599	Category 2 forged right or left straight lift arm repair end; 1-1/8" pin hole; 5" overall length
70000-16574	Category 1 lift arm leveling assembly; 18-1/2" closed; 25" open length; 7/8" NF thread diameter; replaces Ford NCA577A



Stabilizer Arms, Bracket, Stabilizer Pin & Ratchet Jack

- Replacement stabilizer arms for stabilizer kits and a variety of tractors. Stabilizer arms increase the stability of the tractor lift arms. Stay straps for Cat. 1 tractors are used to maintain an implement at a set height.
- Stabilizer stub pins for Ford, Ferguson and other stabilizer kits
- Yellow zinc dichromate plated and black powder coat paint
- Ratchet jacks have multiple uses including the adjustment of implements and equipment. They replace hydraulic cylinders or old screw jacks in those applications where infrequent adjustment is needed.



Item No.	Description
70000-16599	Upper stay strap for Category 1; fits all Ferguson models, Ford 2N, 8N, 9N, NAA, 600, 700, 800, 900, Oliver 550 and all Oliver 3-point conversions, Massey-Ferguson 35 and 50; painted black
70000-16600	Lower stay strap for Category 1; fits all Ferguson models, Ford 2N, 8N, 9N, NAA, 600, 700, 800, 900, Oliver 550 and all Oliver 3-point conversions, and Massey-Ferguson 35 and 50; painted black
70000-16603	Right or left universal stabilizer arm; 7/8" pin holes on 31-9/16" centers; painted black
70000-16604	Right or left universal stabilizer arm; replaces Massey-Ferguson ST96362358; 7/8" pin holes on 33-1/8" centers; painted black
70000-16605	Heavy duty adjustable forged stabilizer arm; fits all Ferguson models, Ford 2N, 8N, 9N, NAA, 600, Massey-Ferguson 35, 50, 175, 65, 135, 150, 165, 180; adjustable from 28-1/2" to 36"; 7/8" pin holes; 7/8" NF threads; yellow zinc plated
70000-16606	Right or left universal stabilizer bracket; Ferguson and Ford stabilizer kits; accommodates 70000-16629 stabilizer stub pin; painted black
70000-16629	Stabilizer Pin: Pin Diameter 7/8", Usable Length 3/8", Overall Length 2-5/8", Thread Diameter 5/8" NF
70000-16575	Ratchet Jack: Heavy duty ratchet jack with 1-1/4" ACME threads and grease zerks; adjustable from 20" closed to 28" open; 1" clevis pins, clip pins and handle included; color black

Draw Pins (Lift Arm Pins)

- Forged and adjustable Category 0 through 2 draw pins for a variety of applications
- All pins are yellow zinc dichromate plated
- See page 7 for a linkage pin countertop display



Item No.	Cat.	Description	Pin Diameter	Usable Length	Overall Length	Thread Diameter	Thread Length
70000-16614	0	Adjustable; universal	5/8"	Adjustable	3-7/8"	5/8" NF	2"
70000-16608	1	Adjustable; universal	7/8"	Adjustable	5"	7/8" NF	2-5/8"
70000-16610	1	Forged; universal	7/8"	1-3/4"	5-1/2"	7/8" NF	1-5/8"
70000-16613	1	Adjustable; universal; extra long	7/8"	Adjustable	6-1/4"	7/8" NF	3-1/2"
70000-73952	1	Forged; extra long	7/8"	2-1/4"	6-1/2"	7/8" NF	2-1/4"
70000-73425	1-2	Forged; to work Cat. 1 implements on Cat. 2 tractor	1-1/8"	1-13/16"	5-1/4"	7/8" NF	1-5/8"
70000-16609	1-2	Adjustable; to work cat. 1 implements on cat. 2 tractors	1-1/8"	Adjustable	5-1/4"	7/8" NF	2-7/16"
70000-16607	2	Adjustable; universal	1-1/8"	Adjustable	6-1/8"	1-1/8" NF	3-3/8"
70000-16612	2	Forged; universal	1-1/8"	1-3/4"	6-1/8"	1-1/8" NF	2-3/8"



Top Link Pins

- Sizes and styles for Category 0 Through 2 tractors
- Yellow zinc dichromate plated
- See page 7 for a linkage pin countertop display

Item No.	Cat.	Description	Pin Diameter	Usable Length	Overall Length
70000-16624	0	Top link pin	5/8"	3"	4-7/16"
70000-16621	1	Replaces Ford 9N-560, Ferguson 195647M1	3/4"	2-3/4"	4-1/2"
70000-16622	1	Long top link pin; replaces Ferguson 195589M1, AC339942	3/4"	3-7/8"	5-1/2"
70000-16626	1	Extra long top link pin; replaces Ford E381T9	3/4"	4-3/4"	6-3/8"
70000-73956	2	Replaces Ford C5NN560A, MF185873M91, AC2090149/239888	1"	3-9/16"	5-1/4"
70000-16623	2	Replaces Ford C5NN486A	1"	4-3/8"	6"

Swivel Handle Forged Hitch Pins

- Forged head hitch pin with swivel handle and zinc plated “R” clip pin
- More than 25% stronger than Grade 2
- Yellow zinc dichromate plated
- See page 7 for countertop display



Item No.	Pin Diameter	Usable Length	Overall Length
77700-06397	3/8"	3-1/2"	5"
70000-73957	3/8"	4-1/4"	5-3/4"
77700-06398	1/2"	3-1/2"	5"
70000-73426	1/2"	4-1/4"	5-3/4"
70000-73428	5/8"	4-1/4"	5-3/4"
70000-16641	3/4"	4-1/4"	5-3/4"
77700-06393	1"	4-1/4"	5-3/4"

Item No.	Pin Diameter	Usable Length	Overall Length
70000-73427	1/2"	6-1/4"	7-3/4"
70000-16640	5/8"	6-1/4"	7-3/4"
70000-16642	3/4"	6-1/4"	7-3/4"
70000-73958	7/8"	4-1/4"	5-3/4"
70000-16643	7/8"	6-1/4"	7-3/4"
70000-16644	1"	6-1/4"	7-3/4"
70000-73429	1-1/8"	6-1/4"	7-3/4"
70000-73576	1-1/4"	6-1/4"	7-3/4"

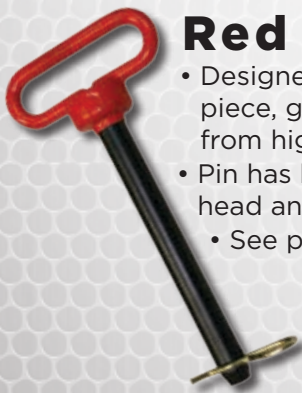

Red Head Hitch Pins

- Designed for today’s demanding applications, these one piece, grade 5 performance, forged hitch pins are made from high strength steel and heat treated
- Pin has black powder coating with a red vinyl coated head and handle. Zinc plated “R” clip pin included
 - See page 7 for the display

Item No.	Pin Diameter	Usable Length	Overall Length
70000-73959	1/2"	3-5/8"	6-5/8"
70000-73960	5/8"	4"	7"
70050-94463	5/8"	5-3/4"	9"
70000-73754	3/4"	4"	7"
70000-73750	3/4"	6-1/2"	9-1/2"
70000-73752	7/8"	6-1/2"	9-1/2"
70000-73751	1"	7-1/2"	10"
70000-73755	1-1/8"	8-1/2"	11-1/2"
77700-06413	1-1/4"	8-1/2"	11-1/2"
7000-73757	1-1/2"	8-1/2"	11-1/2"

Bent Hitch Pins

- These pins have numerous farm, lawn and garden and industrial applications
- Complete with zinc plated “R” clip pin
- Yellow zinc dichromate plated

Item No.	Pin Diameter	Usable Length
77700-06394	1/2"	3"
77700-06395	5/8"	3"
77700-06396	3/4"	3-1/2"



“R” Clip Pins & “R” Clip Pin Assortment

- Available in the most popular sizes for farm and other applications
- Yellow zinc dichromate plated spring wire

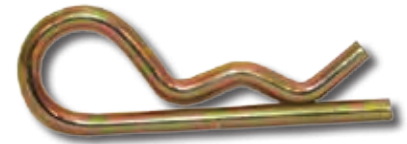

Item No.	Wire Diameter	Overall Length	Fits Pin Diameter
70000-16645	1/16"	1-9/16"	3/8" to 1/2"
70000-16646	3/32"	1-5/8"	1/4" to 1/2"
70000-16647	1/8"	1-15/16"	1/2" to 3/4"
70000-16648	5/32"	2-15/16"	5/8" to 1"
70000-16649	3/16"	3-3/4"	7/8" to 1-1/4"
70000-16650	1/4"	4"	3/4" to 1"
77700-06415	Hitch pin clip assortment in plastic blister box; contains 3- 70000-16646, 4- 70000-16647, 4- 70000-16648 and 3- 70000-16649		



77700-06415

Lynch Pins



- Fasteners for numerous farm and other applications
- Yellow zinc dichromate plated except for the S07091300 which has a black powder coated finish
- See page 7 for the countertop assortment

70000-73593



70000-73577



70000-73578

Item No.	Description	Pin Diameter	Usable Length	Shank Length	Overall Length
70000-73961	Standard	3/16"	1"	1-3/8"	1-5/8"
70000-73577	Standard	7/16"	1-1/4"	1-3/4"	2"
70000-73578	S07090100 with chain and cotter pin	7/16"	1-1/4"	1-3/4"	2"
70000-73579	Standard	1/4"	1-1/4"	1-3/4"	2-1/8"
77700-06383	Standard	5/16"	1-1/4"	1-3/4"	2-1/8"
70000-73593	Heavy duty; fits Cat. 1, 2 and 3 pins	7/16"	1-1/2"	1-3/4"	2-1/8"
77700-06420	Long; fits Cat. 1, 2 & 3 pins	7/16"	1-3/4"	2"	2-5/16"

Lock Pins

- Numerous farm, lawn and garden, and industrial applications
- Round and square loop styles
- Yellow zinc dichromate plated
- See page 7 for countertop assortment

Item No.	Diameter	Usable Length	Wire Loop
70000-73866	1/4"	1-3/4"	Round
77700-06389	1/4"	2-1/2"	Round
70000-73867	5/16"	2-1/4"	Square
70000-73594	5/16"	2-1/4"	Round
70000-73869	3/8"	2-1/4"	Round
77700-06390	3/8"	2-1/4"	Square



Hitch Pin Assortments

Red Head	
Item No.	Description
77700-06403	Grade 5 red head hitch pin assortment on wire rack with header sign; contains 6- 70050-94463, 8-70000-73754, 8- 70000-73750, 4- 70000-73752 and 3- 70000-73751
77700-06931	Red Head Hitch Pin Header Card ONLY
Swivel Handle	
Item No.	Description
77700-06402	Forged swivel handle hitch pin assortment on wire rack with header sign; contains 6- 70000-16640,6-70000-16641, 6- 70000-16642, 3- 70000-16643 and 3- 70000-16644
77700-06930	Swivel Handle Hitch Pin Header Card ONLY
77700-06846	Hitch Pin Wire Rack ONLY



Linkage Pin Assortment

Item No.	Description
77700-06401	Universal linkage pin assortment on wire rack with header sign; features the most popular Category 1 and 2 top link pins and draw pins; contains 4- 70000-16621, 4- 70000-16622, 3-70000-73956, 3- 70000-16623, 4- 70000-16608, 4-70000-16610, 3- 70000-16613, 3- 70000-73952, 3- 70000-16609, 3-70000-73425, 4- 70000-16607 and 3- 70000-16612
77700-06799	Linkage Pin Wire Rack ONLY
77700-06929	Linkage Pin Header Card ONLY

Bushing Assortment

Item No.	Description
77700-06400	Bushing assortment in counter top display carton with emphasis on Cat. 1-2; contains 10- 70000-16635, 28- 70000-16632, 6- 70000-16637, 6- 70000-16636 and 4- 70000-16638



Lynch Pin Assortment

Item No.	Description
77700-06399	Lynch pin assortment counter top display; contains 15- 77700-06383, 15- 70000-73961, 20- 70000-73593, 30- 70000-73577, 15- 70000-73578, 30- 70000-73579 and 10- 77700-06420

Lock Pin Assortment

Item No.	Description
77700-06404	Lock Pin Display; contains 8- 70000-73867, 28- 70000-73594, 8- 70000-73869, 8- 77700-06389, 8- 77700-06390

